



TORNILLOS

Bolts

Uso Sujetar herrajes en estructuras en líneas y redes de media y alta tensión.

Mat Tornillo máquina cabeza hexagonal grado A, con rosa UNC 2A,
Tornillo estructural cabeza hexagonal tipo T pesado, con rosa UNC 2A,
1 tuerca hexagonal, 1 arandela de presión.

Aca Galvanizado por inmersión en caliente norma NMX-H-004-2008.

CFE 67B00-04

| CÓDIGO CONHESA | PRODUCTO TORNILLO | DIMENSIONES | | | MASA APROX. KG. x 100 pz | EMPAQUE PZAS |
|-------------------|----------------------|-------------|-------|-----|-----------------------------|-----------------|
| | | D | L | L1 | | |
| TORM-01 | MAQUINA 9 X 114 | 9.52 | 114.3 | 38 | 7.35 | 400 |
| TORM-10 | MAQUINA 13 X 152 | 12.70 | 152.4 | 100 | 17.40 | 170 |
| TORM-11 | MAQUINA 13 X 203 | 12.70 | 203.2 | 100 | 22.20 | 135 |
| TORM-13 | MAQUINA 16 X 63 | 15.88 | 63.5 | 60 | 15.20 | 195 |
| TORM-15 | MAQUINA 16 X 76 | 15.88 | 76.2 | 75 | 17.10 | 175 |
| TORM-17 | MAQUINA 16 X 152 | 15.88 | 152.4 | 100 | 28.50 | 105 |
| TORM-18 | MAQUINA 16 X 203 | 15.88 | 203.2 | 100 | 35.90 | 85 |
| TORM-19 | MAQUINA 16 X 254 | 15.88 | 254 | 100 | 43.60 | 70 |
| TORM-20 | MAQUINA 16 X 305 | 15.88 | 304.8 | 150 | 51.30 | 60 |
| TORM-21 | MAQUINA 16 X 356 | 15.88 | 355.6 | 205 | 58.80 | 50 |
| TORM-22 | MAQUINA 16 X 406 | 15.88 | 406.4 | 205 | 66.30 | 45 |
| TORM-23 | MAQUINA 16 X 457 | 15.88 | 457.2 | 205 | 73.80 | 40 |
| TORM-24 | MAQUINA 16 X 508 | 15.88 | 508 | 205 | 81.30 | 40 |
| TORM-26 | MAQUINA 16 X 610 | 15.88 | 609.6 | 205 | 97.05 | 30 |
| TORM-29 | ESTRUCTURAL 19 X 76 | 19.05 | 76.2 | 75 | 32.20 | 90 |
| TORM-30 | ESTRUCTURAL 19 X 203 | 19.05 | 203.2 | 100 | 60.30 | 50 |
| TORM-31 | ESTRUCTURAL 19 X 254 | 19.05 | 254.0 | 100 | 70.70 | 45 |
| TORM-32 | ESTRUCTURAL 19 X 305 | 19.05 | 304.8 | 150 | 82.87 | 35 |
| TORM-33 | ESTRUCTURAL 19 X 356 | 19.05 | 355.6 | 150 | 93.93 | 35 |
| TORM-39 | ESTRUCTURAL 19 X 380 | 19.05 | 381 | 205 | 99.46 | 30 |
| TORM-34 | ESTRUCTURAL 19 X 406 | 19.05 | 406.4 | 205 | 104.99 | 30 |
| TORM-35 | ESTRUCTURAL 19 X 457 | 19.05 | 457.2 | 205 | 116.50 | 25 |
| TORM-36 | ESTRUCTURAL 19 X 508 | 19.05 | 508 | 205 | 127.78 | 25 |

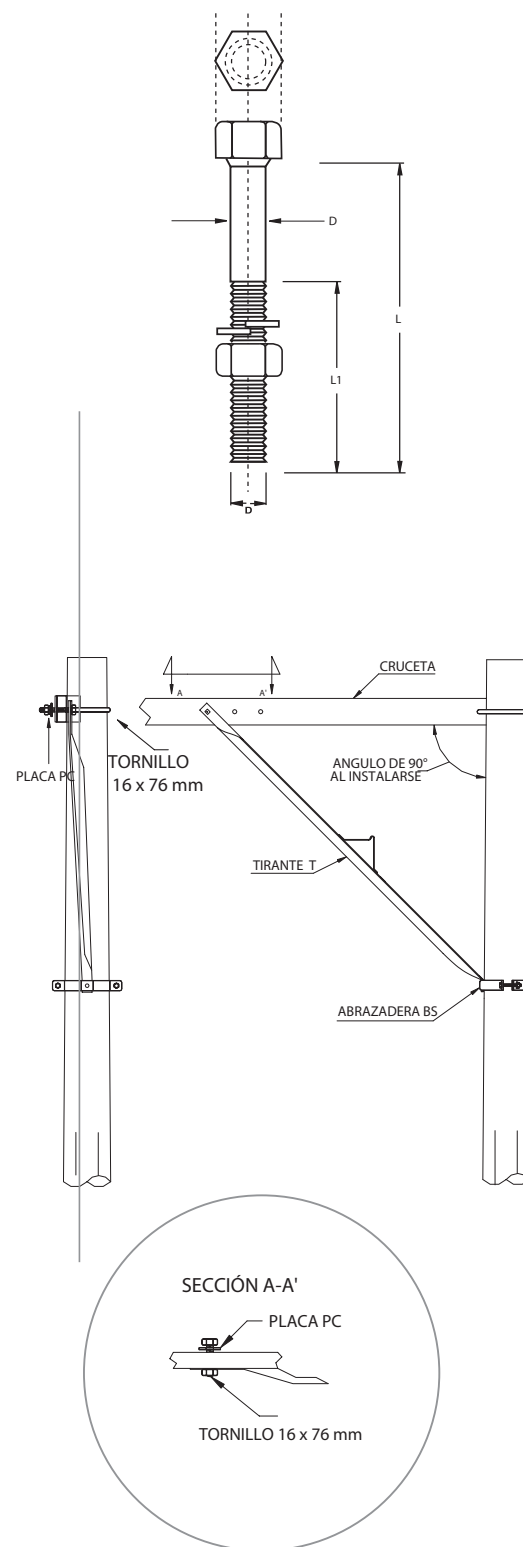
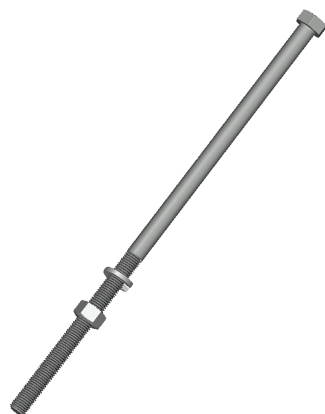

Acotaciones en mm. Sin escala